

Accessory for Ring Lights - Attachment ring M103x0.5

Short description: for R-CLR-100x73 and RK3652, for attachment of beam shaping optics

Order number: 1-29-750



Characteristics

- attachment ring made of anodised aluminium
 - attachment on the lighting is made with Attachment ring M40x0.5
 - The use of several beam shape optics is possible
-

Technical data

Can be combined with:

Ring light

R-CLR-100x73
RK3652

Drawings

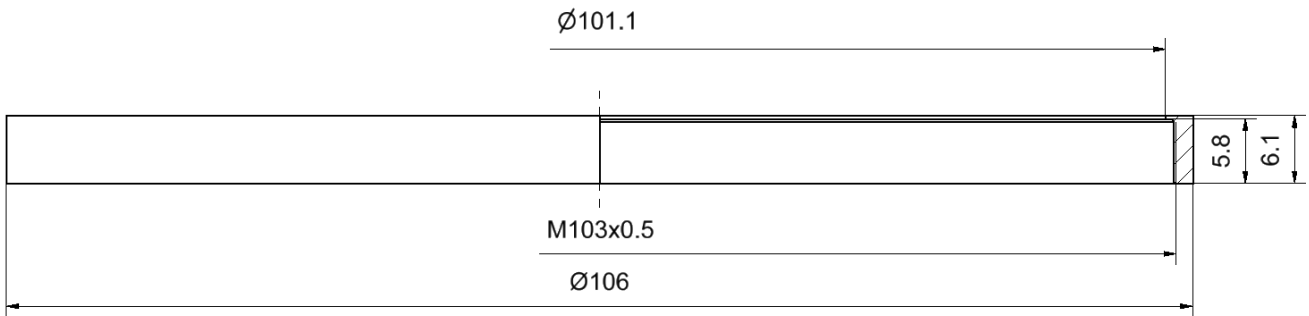

Dimensional drawing in mm